

DELTA[®]

DELTA[®] protects property. Creates comfort. Saves energy.



COSELLA DÖRKEN

DELTA[®]-DRY

**Ventilated Rainscreen
For Absorptive Cladding.™**

**DELTA[®]-DRY
STUCCO & STONE**



P R E M I U M Q U A L I T Y



- For protection of buildings against the elements of weather
- Controls moisture in wall assemblies
- Provides ventilation and drying behind absorptive cladding.

The Premier Choice in a Rainscreen Solution



Ideal behind absorptive cladding:

- Manufactured Stone Veneer
- Conventional Stucco
- Cement Board Cladding
- Brick Veneer
- Natural Stone

Ideal over moisture-sensitive substrates:

- OSB
- Plywood
- Exterior grade sheathing

What Does A Rainscreen Do?

- Sheds water at the outer cladding and prevents water from collecting at the building face.
- Provides an appropriately sized cavity for pressure moderation and capillary break.
- Allows for continuous drainage of the cavity at the outer face of the wall.
- Has additional drainage on the warm side.
- Creates proper ventilation of the cavity to improve drying.
- Has sufficient rigidity and durability to withstand wind load and resist deflection.
- Acts as a key component of the wall structure.
- Adds to the life of the wall and its insulated and structural components.

Reliable Long Term Protection

DELTA[®]-DRY

High Performance Rainscreen System

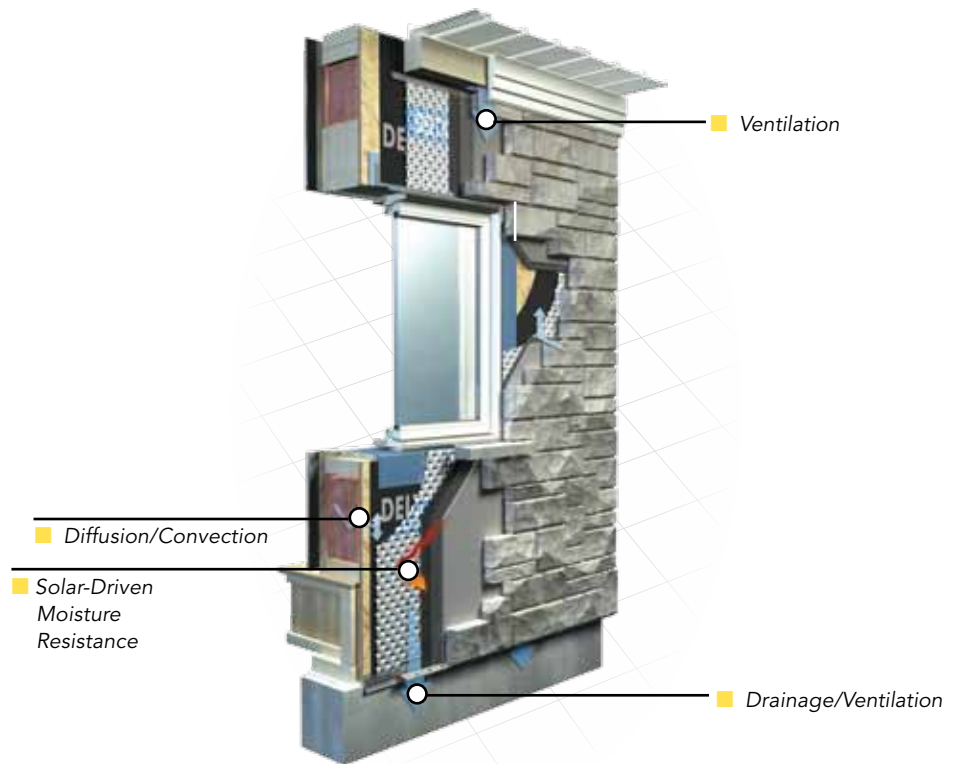

DELTA[®]-DRY STUCCO & STONE

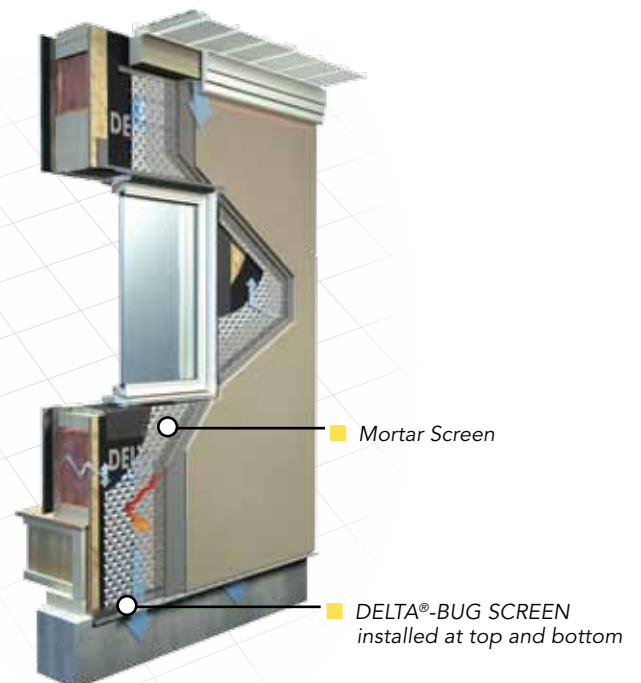



DELTA®-DRY Optimize Wall Drainage & Drying Mechanisms

Excellent Water Resistance

- Prevents bulk water intrusion
- Adds a secondary moisture barrier
- Resists inward moisture transport

Stops Solar-driven Moisture

- Impedes inward drive of moisture through absorptive cladding by the sun's heat
- Provides moisture safety buffer under exterior cladding like conventional stucco, manufactured stone, cement board sidings, and brick veneer

Full Capillary Break

- Impermeable to moisture migration
- Prevents water from crossing the wall cavity

Outstanding Drainage Capacity

- Dual-sided drainage plane
- High volume dimple design
- Directs water out of the cavity

Exceptional Drying Capability

- Exclusive 3-D design allows rapid drying
- Dries on both sides of the membrane
- Allows multi-directional drying air flow

Moderates Cavity Pressure

- Reduces pressure differentials that draw water into wall cavity

Technologically Advanced

- Outperforms regular wood strapping
- Won't rot, warp, or trap water like wood strapping

Extremely Durable

- Made from a special high strength HDPE
- Withstands jobsite rigors
- Long service life

Easy to Install

- Requires no special tools
- Has easy-to-follow installation details

Performance tested

- Exhaustive testing by Oak Ridge National Laboratory, BSC and University of Waterloo confirms the high performance and effectiveness.

Approval

ICC-ESR # 2987, Moisture Drainage System used with exterior cement plaster or adhered masonry veneer walls.

DELTA®-DRY STUCCO & STONE Ventilated Rainscreen with Pre-installed Mortar Screen for Manufactured Stone and Conventional Stucco Claddings.™

DELTA®-DRY STUCCO & STONE has a mortar screen factory-installed on the exterior side of the membrane. This prevents scratch coats from filling the drainage and ventilation channels during application.

DELTA®-DRY STUCCO & STONE has all of the outstanding drainage and drying qualities of DELTA®-DRY with the addition of the labor-saving pre-installed mortar screen.

DELTA®-DRY STUCCO & STONE ...

- ... specially designed for stucco and stone applications.
- ... easy and fast to install.
- ... saves labor.
- ... stops solar driven moisture, unlike open fiber mesh.
- ... environmentally friendly, recyclable.
- ... same performance tested and technologically advanced qualities as DELTA®-DRY.



TECHNICAL DATA

Properties	Test Method	Test Results*
Core	High Density Polyethylene stabilized against oxidation and UV light	
Overall Thickness	ASTM D1777-96 (2002) Measured @ 2.0 kPa	10.53 mm (0.42")
Standard Roll Size		1 m x 15.24 m (3'3" x 50')
Fungi Resistance	ASTM C1338	Pass
Compressive Strength	ASTM D6364 Compressive Strength	93 kN/sqm 1942 lb/ft ²
UV Aging	AC356-2009	Pass
Water Vapor Transmission	ASTM E96/E96M-05 (Method A) • Water Vapor Permeance • Perms	22 ng / (Pa·s·m ²) 0.385 perms
Water Penetration Resistance	AATCC 127-1995	118 psi
Water Ponding	CCMC 07102, Section 6.4.5	Pass (no water seepage)

* Independent test results available upon request
DELTA®-DRY exposure time: 30 days

DELTA® Premium Rainscreen Solution

Feature	Advantage	Benefit
<ul style="list-style-type: none"> 3-Dimensional dimples 	<ul style="list-style-type: none"> High capacity 2-sided rapid drainage Dual air space creates active ventilation 	<ul style="list-style-type: none"> Wall stays dry Wet walls dry out & life added to OSB Water does not stay in cavity
<ul style="list-style-type: none"> Solid HDPE construction 	<ul style="list-style-type: none"> Provides physical barrier against water Capillary break prevents capillary wicking Very durable 	<ul style="list-style-type: none"> Keeps bulk (liquid) water out Resists damage during construction phase
<ul style="list-style-type: none"> Impermeable membrane 	<ul style="list-style-type: none"> Prevents inward moisture vapor migration Stops solar-driven moisture 	<ul style="list-style-type: none"> Reduces humidity in cavity Keeps outside moisture outside Does what open meshes can't
<ul style="list-style-type: none"> Exhaustively tested 	<ul style="list-style-type: none"> Proven effectiveness 	<ul style="list-style-type: none"> Can be installed with confidence

DELTA® is a registered trademark of Ewald Dörken AG, Herdecke, Germany

DELTA®

DELTA® SUSTAINABLE SCIENCE

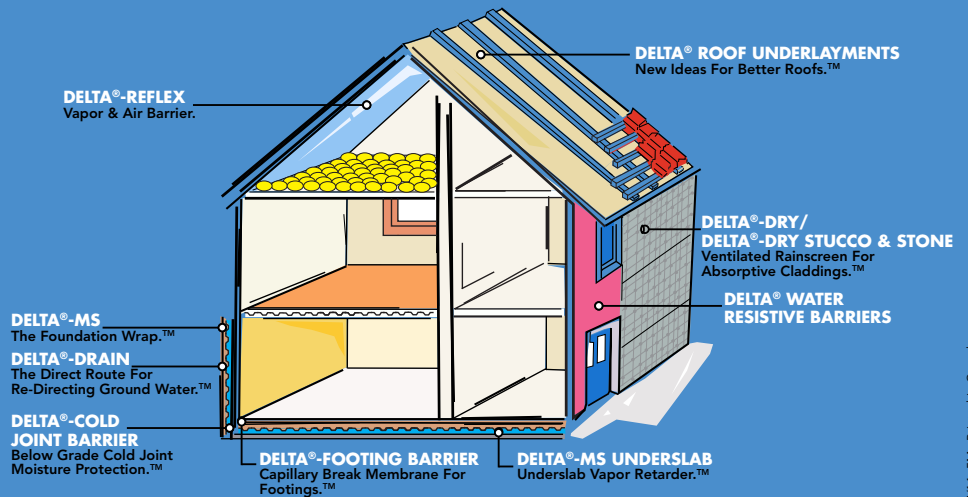

DELTA® products from Cosella-Dörken offer a complete building envelope solution to protect homes against moisture damage.

CD 07/11 5M Printed in Canada

COSELLA DÖRKEN

Cosella-Dörken Products Inc.
4655 Delta Way
Beamsville, Ontario
LOR 1B4
(905) 563-3255
Fax: (905) 563-5582
1-888-4 DELTA 4
info@cosella-dorcken.com
www.delta-dry.com

The information printed in this brochure reflects product information and specifications at the date of printing. The manufacturer reserves the right to make changes when necessary.



DELTA®-branded quality products manufactured by Cosella-Dörken.

