

**DELTA**<sup>®</sup> System

DELTA<sup>®</sup> protects property. Saves energy. Creates comfort.

**DELTA**<sup>®</sup>

**Premium Moisture Management  
Systems For Walls.**

**COSELLA DÖRKEN**



**PREMIUM  
QUALITY**

# DELTA<sup>®</sup> System

DELTA<sup>®</sup> Premium Moisture Management Systems for walls provide the best protection and margins of safety for building enclosures.

Using a Systems approach helps manage moisture, both as liquid and as vapor, within the building enclosure. Uncontrolled moisture can lead to mold, mildew and structural decay that will dramatically shorten the service life of the structure.

DELTA<sup>®</sup>-DRY and DELTA<sup>®</sup>-DRY STUCCO & STONE provide margins of safety for buildings clad in absorptive materials like conventional stucco, manufactured stone or cement board. These products provide unrivalled drainage behind claddings, as well as a capillary break. They also create superior drying ability to reduce the time any structure is at risk of decay from being wet.

In combination with DELTA<sup>®</sup>-DRY and DELTA<sup>®</sup>-DRY STUCCO & STONE or stand alone, the broad line of DELTA<sup>®</sup> Water-resistive Barriers (WRB's) helps make a building energy-efficient, air tight and long-lasting. DELTA<sup>®</sup> WRB's come in a wide range of vapor permeabilities to suit any project in any climate.

DELTA<sup>®</sup> Premium Moisture Management Systems ensure a durable and sustainable energy-efficient structure.





## INDEX

<b>DELTA®-DRY</b> .....	4
Ventilated Rainscreen For Absorptive Cladding.™	
<b>DELTA®-DRY STUCCO &amp; STONE</b> .....	5
Ventilated Rainscreen with Pre-installed Mortar Screen for Manufactured Stone and Conventional Stucco Claddings.™	
<b>DELTA®-FASSADE S</b> .....	6
UV-resistant Water-resistive Barrier for Open Joint Claddings.™	
<b>DELTA®-VENT S</b> .....	7
Highly Permeable Water-resistive Barrier for Maximum Security.™	
<b>DELTA®-MAXX</b> .....	8
Permeable Water-resistive Barrier for Reliable Protection in Extreme Conditions.™	
<b>DELTA®-FOXX</b> .....	8
Most Advanced Permeable Water-resistive Barrier on the Market.™	
<b>DELTA® ACCESSORIES</b> .....	9
<b>DELTA® SUSTAINABLE SCIENCE</b> .....	10
<b>NOTES</b> .....	11

## DELTA®-DRY

### Ventilated Rainscreen For Absorptive Cladding.™

DELTA®-DRY optimizes wall drainage and drying mechanisms.

#### DELTA®-DRY ...

- ... offers excellent water resistance with exceptional drying capabilities.
- ... has a unique 2-sided 3-dimensional structure.
- ... provides a full capillary break.
- ... has outstanding drainage capacity.
- ... stops solar driven moisture, unlike open fiber mesh.
- ... is extremely durable and long-lasting.
- ... is easy to install.
- ... is performance tested and technologically advanced.

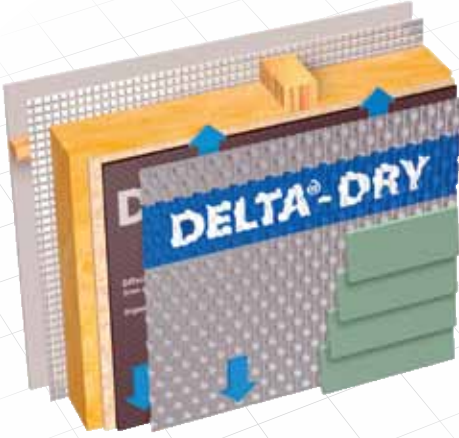

ICC ESR-2987





# DELTA®-DRY STUCCO & STONE

## Ventilated Rainscreen with Pre-installed Mortar Screen for Manufactured Stone and Conventional Stucco Claddings.™

DELTA®-DRY STUCCO & STONE has a mortar screen factory-installed on the exterior side of the membrane. This prevents scratch coats from filling the drainage and ventilation channels during application.

DELTA®-DRY STUCCO & STONE has all of the outstanding drainage and drying qualities of DELTA®-DRY with the addition of the labor-saving pre-installed mortar screen.

### DELTA®-DRY STUCCO & STONE ...

- ... specially designed for stucco and stone applications.
- ... easy and fast to install.
- ... saves labor.
- ... stops solar driven moisture, unlike open fiber mesh.
- ... environmentally friendly, recyclable.
- ... same performance tested and technologically advanced qualities as DELTA®-DRY.

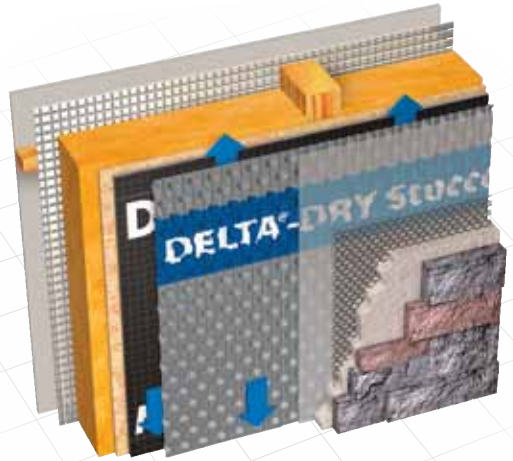

ICC ESR-2987





ICC ESR-2932

## DELTA®-FASSADE S

**UV-resistant Water-resistant Barrier for Open Joint Claddings.™**

### DELTA®-FASSADE S ...

- ... consists of a highly tear-resistant polyester substrate with a waterproof special coating.
- ... is exceptionally UV-resistant.
- ... may be installed in all back-vented cladding systems featuring open joints up to 2" (50 mm) wide and open joint areas of up to 40% of the entire surface.
- ... is highly vapor permeable (74 perms).
- ... helps to ensure a healthy and comfortable interior climate in stud wall construction due to its excellent physical properties.
- ... may be used in metal stud construction.
- ... is unaffected by surfactants.
- ... is very easy to install.
- ... no sacrificial layers.
- ... no seam reinforcing required.
- ... available in a PLUS version with a self-adhesive edge.



# DELTA®-VENT S

**Highly Permeable Water-resistive Barrier for Maximum Security.™**

DELTA®-VENT S is a highly vapor permeable WRB and air barrier for energy-efficient building enclosure. It is a key part of an air and water-tight wall system.

## DELTA®-VENT S ...

- ... is highly vapor permeable (120 perms).
- ... does not trap moisture vapor.
- ... may be used as an air barrier.
- ... is water tight and Class A fire-rated.
- ... is a 3 layer membrane.
- ... is light-weight yet very strong and tear resistant.
- ... matte gray color is easy on the eyes.
- ... is unaffected by surfactants.
- ... available in a PLUS version with a self-adhesive edge.

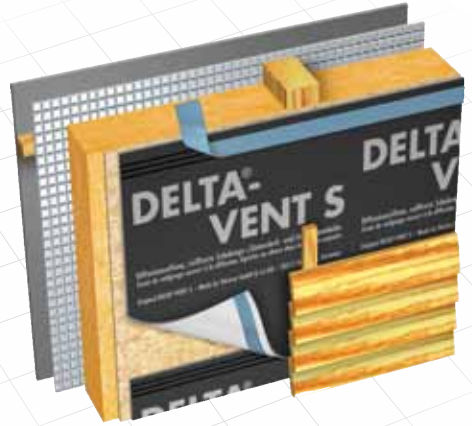

ICC ESR-2932  
CCMC 13479-R



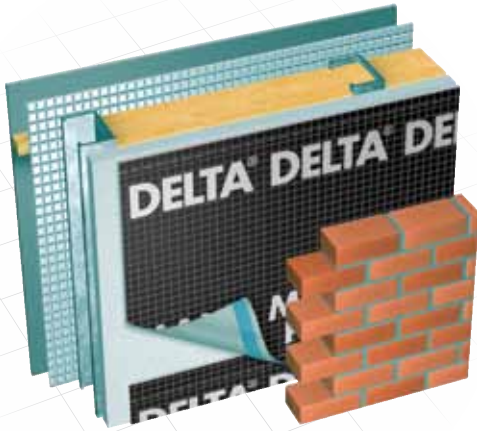

ICC ESR-2932

## DELTA®-MAXX

**Permeable Water-resistant Barrier for Reliable Protection in Extreme Conditions.™**

DELTA®-MAXX is ideal for use in the most extreme conditions. Its unique polyester backing acts as a reservoir during extreme wetting conditions and releases excess moisture over time.

### DELTA®-MAXX ...

- ... has a highly tear-resistant polyester substrate.
- ... has a vapor permeable polyurethane coating (30 perms).
- ... has a special edge design that prevents capillary wicking of moisture at overlaps.
- ... exceeds the requirements of a 60 min building paper.
- ... may be used as the air barrier.
- ... is Class A fire-rated and unaffected by surfactants.
- ... is available in a PLUS version with self-adhesive edges.

## DELTA®-FOXX

**Most Advanced Permeable Water-resistant Barrier on the Market.™**

DELTA®-FOXX is the most highly permeable WRB on the market. This technically advanced 2 ply WRB will allow moisture vapor to escape from buildings very quickly while remaining water tight.

### DELTA®-FOXX ...

- ... is very vapor permeable (550 perms).
- ... has an anti-glare, water tight acrylic dispersion coating.
- ... is very strong and tear-resistant to resist job site rigors and challenging weather.
- ... is light-weight and easy to manage.
- ... is Class A fire-rated and unaffected by surfactants.
- ... is available in a PLUS version with self-adhesive edges.

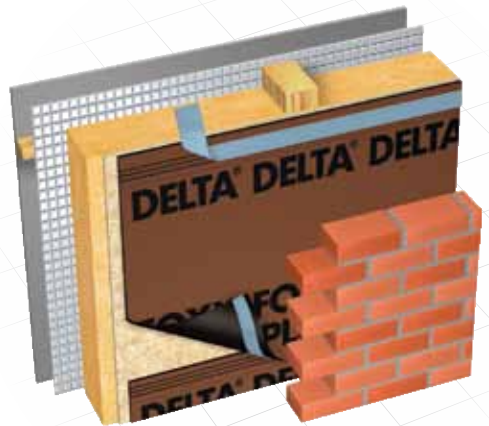

ICC ESR-2932



## DELTA® ACCESSORIES



### DELTA®-MULTIBAND

For use with DELTA® WRB's. It is a highly aggressive tape that may be used on end laps, side laps and at penetrations.



### DELTA®-FLEXX BAND

For use with all DELTA® WRB's. It is a highly aggressive and very flexible tape that may be used anywhere permanent sealing is required.



### DELTA®-THAN

For use with all DELTA® WRB's. Highly tacky elastic sealing compound and adhesive.



### DELTA®-FASSADE TAPE

For use with DELTA®-FASSADE S. It is UV resistant and is used to seal end laps, side laps or anywhere requiring UV protection. It is available in a 2" (25 mm) width.



### DELTA®-FASSADE FLASHING

For use with DELTA®-FASSADE S. It is UV resistant and used to flash windows and doors. It is available in 4" (50 mm) or 9" (125 mm) widths.

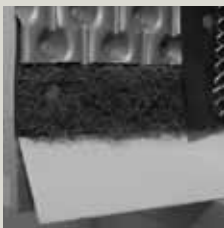

### DELTA®-BUG SCREEN

For use with DELTA®-DRY and DELTA®-DRY STUCCO & STONE. Used at ventilation points to keep insects out.

## DELTA® SUSTAINABLE SCIENCE

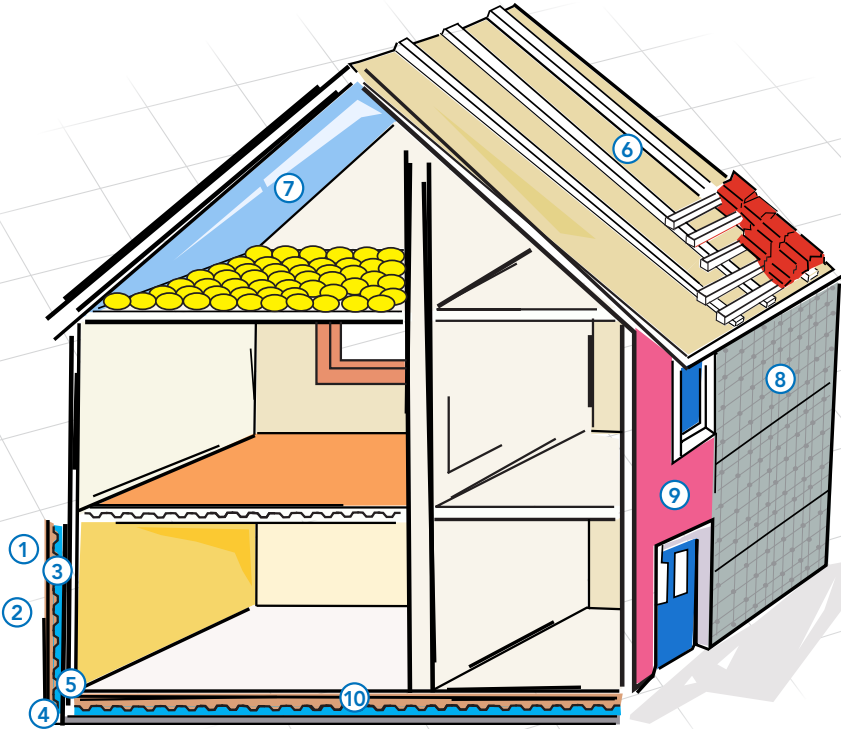

- 1 **DELTA®-MS**  
The Foundation Wrap.™
- 2 **DELTA®-DRAIN**  
The Direct Route For Re-Redirecting Ground Water.™
- 3 **DELTA®-THENE**  
Self Adhering Waterproof Membrane.™
- 4 **DELTA®-COLDJOINT BARRIER**  
Below Grade Cold Joint Moisture Protection.™
- 5 **DELTA®-FOOTING BARRIER**  
Capillary Break Membrane For Footings.™
- 6 **DELTA® ROOF UNDERLAYMENTS**  
New Ideas For Better Roofs.™
- 7 **DELTA®-REFLEX**  
Vapor & Air Barrier.
- 8 **DELTA®-DRY/ DELTA®-DRY STUCCO & STONE**  
Ventilated Rainscreens For Absorptive Cladding.™
- 9 **DELTA® WATER-RESISTIVE BARRIERS**
- 10 **DELTA®-MS UNDERSLAB**  
Underslab Vapor Retarder.™





Printed in Canada 5/11 v1 1m

# DELTA®

**COSELLA DÖRKEN**

Cosella-Dörken Products Inc.  
4655 Delta Way  
Beamsville, Ontario  
L0R 1B4  
(905) 563-3255  
Fax: (905) 563-5582  
1-888-4DELTA4(433-5824)  
info@cosella-dorcken.com  
www.cosella-dorcken.com

A company of the Dörken Group

The information printed in this brochure reflects product information and specifications at the date of printing. The manufacturer reserves the right to make changes when necessary.



**Canadian**  
Home Builders'  
Association



Member  
**NAHB**  
NATIONAL ASSOCIATION  
OF HOME BUILDERS

DELTA®-branded quality products manufactured by Cosella-Dörken.

DELTA® is a registered trademark of Ewald Dörken AG, Herdecke, Germany