

# DELTA<sup>®</sup>-FASSADE S

## Water-Resistive Barrier (WRB) For Open Joint Cladding Systems. Installation Instructions With Window Not Installed.

### Health and Safety

- Required safety equipment: hard hat, safety boots, gloves, safety glasses, fall arrest equipment.
- Always follow all safety precautions as directed by the Occupational Safety and Health Administration (OSHA-USA) or the Construction Safety Association (Canada).
- Please refer to Material Safety Data Sheets for all components and observe all recommended safety precautions therein.
- The general codes of practice for protection at work and instructions of the manufacturers for tools and components are to be observed at all times.

### Recommended Materials

- DELTA<sup>®</sup>-FASSADE S
- Acceptable fasteners
- DELTA<sup>®</sup>-FLEXX FLASHING
- DELTA<sup>®</sup>-FASSADE FLASHING (4" and 9")
- DELTA<sup>®</sup>-FASSADE TAPE
- DELTA<sup>®</sup>-THAN sealant

### Recommended Tools

- Utility knife or scissors
- Measuring tape
- Chalk line
- Caulking gun
- Hammer or pneumatic nail/staple gun
- Hammer drill (for masonry applications)
- Cordless drill with bits (for steel stud applications)
- Hand roller

### Notes and Limitations

- These installation instructions for DELTA<sup>®</sup>-FASSADE S are intended only as a guide and are for the convenience of the contractors, specifiers, and other interested parties. The final application and details are the sole responsibility of the design authority on record for the project.
- Install DELTA<sup>®</sup>-FASSADE S with the smooth side facing the installer and the textured side facing the substrate.
- Do not install DELTA<sup>®</sup>-FASSADE S in adverse weather conditions.
- High winds may hamper application.
- The substrate should be dry prior to application.
- Ensure protrusions that may penetrate the membrane are removed from substrate.
- Prior to beginning the installation of the DELTA<sup>®</sup>-FASSADE S, step flashings and kick-out flashings should be installed.
- DELTA<sup>®</sup>-FASSADE S may be installed over structural sheathing board, insulation board, exterior gypsum board, concrete masonry units (CMU), or directly to framing members.
- The substrate on the building will determine what type of fastener will be used.
- Open joint claddings require girts, strapping, or other attachment systems. Where attachment fasteners penetrate the DELTA<sup>®</sup>-FASSADE S without enough sealing pressure, a patch of DELTA<sup>®</sup>-FASSADE FLASHING at the fastening point should be used.

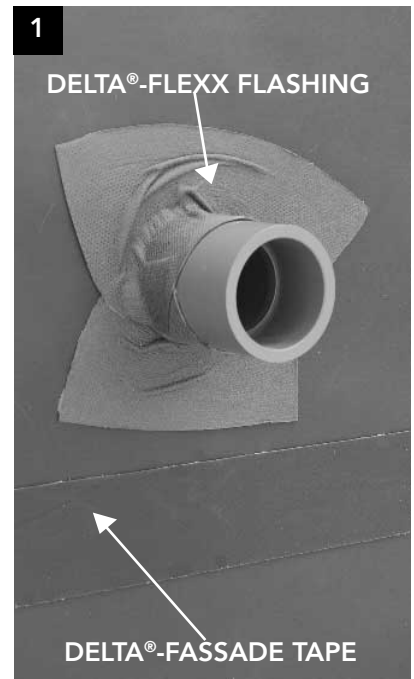

- Acceptable fasteners are:
  - #4 nails with 1" (25 mm) plastic cap (wood frame construction).
  - 1" (25 mm) plastic cap staples with minimum 7/8" (22 mm) leg (wood frame construction).
  - 1-1/4" (32 mm) or 2" (50 mm) self-tapping screws with gasketed metal washers (steel stud construction).
  - Tapcon® fasteners with 2" (50 mm) plastic caps (masonry construction).
- For best adhesion, hand rolling of DELTA®-FASSADE TAPE and DELTA®-FASSADE FLASHING is strongly recommended.
- Maximum exposure time:
  - Full exposure of DELTA®-FASSADE S to ultraviolet light (sunlight) after installation of membrane and prior to installation of cladding shall not exceed 3 months.

## Installation

### Step 1

- Starting at a corner of the building, unroll DELTA®-FASSADE S keeping the roll plumb.
- Extend approximately 12" (300 mm) past either the inside or outside corner of the wall.
- At end (vertical) laps, overlap DELTA®-FASSADE S by a minimum of 6" (150 mm).
- At side (horizontal) laps, overlap DELTA®-FASSADE S by a minimum of 6" (150 mm).
- Always begin the installation of DELTA®-FASSADE S at bottom of the building to ensure proper downward shingling of the laps.

### Step 2

- DELTA®-FASSADE S should overlap through-wall flashing by a minimum of 6" (150 mm).
- For maximum air leakage reduction:
  - Seal DELTA®-FASSADE S at the bottom and top of the wall with DELTA®-THAN or DELTA®-FASSADE FLASHING.
  - If no through-wall flashing is installed, the bottom edge of DELTA®-FASSADE S should extend beyond the sill plate by at least 2" (50 mm) and be sealed with DELTA®-THAN.

### Step 3

- Secure DELTA®-FASSADE S by fastening into the studs (wherever possible) no closer than 6" (300 mm) and no wider than 16" (406 mm) on centre horizontally and vertically.
- Ensure that the DELTA®-FASSADE S is pressed tightly into all inside corners before fastening to prevent damage during the installation of the exterior cladding.

### Step 4

- For maximum air leakage reduction, treat all penetrations.
- Cut DELTA®-FASSADE S around penetrations as tightly as possible. Install a bead of DELTA®-THAN on the substrate, approximately 1" (25 mm) back from the edge of the cut.
- Press the DELTA®-FASSADE S into the DELTA®-THAN. Install DELTA®-FLEXX FLASHING on the exterior of the DELTA®-FASSADE S to join the material to the penetration. (see Detail 1)
- To ensure proper UV (sunlight) protection, cover DELTA®-FLEXX FLASHING that will be exposed on the vertical wall with DELTA®-FASSADE TAPE.

### Step 5

- Unroll DELTA®-FASSADE S directly over window rough openings. (see Detail 2)
- Do not install fasteners within 6" (150 mm) of the sill and jambs of the openings and within 9" (225 mm) of the head of the openings.

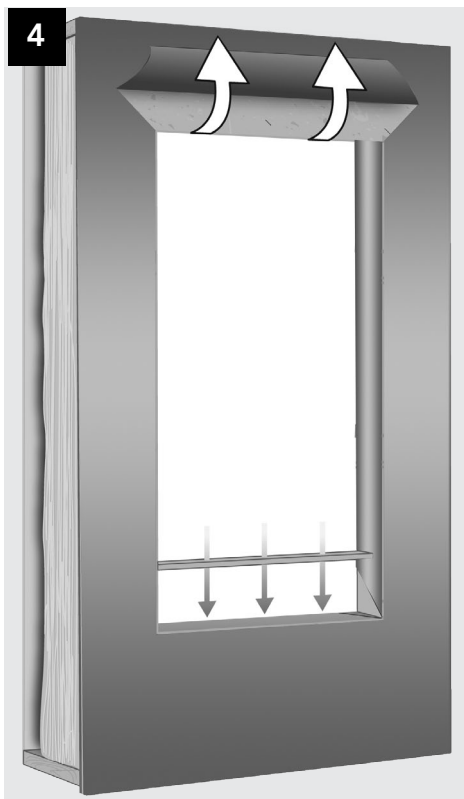
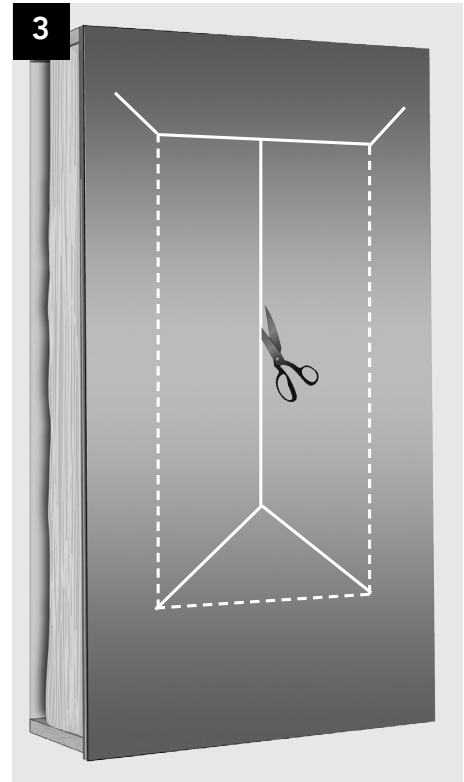

### Step 6

- For maximum air leakage reduction, tape all horizontal and vertical laps and all fasteners with DELTA®-FASSADE TAPE. Horizontal and vertical laps also may be sealed using DELTA®-THAN.

### Step 7

#### Terminations:

- Install a bead of DELTA®-THAN on the substrate approximately 1" (25 mm) back from the edge of the DELTA®-FASSADE S. Press the DELTA®-FASSADE S into the DELTA®-THAN.
- Alternatively, seal the DELTA®-FASSADE S to the substrate with DELTA®-FASSADE TAPE. To provide additional support in high wind locations, install temporary furring strips where the material is terminated. After removal of temporary furring strips, ensure fastener penetrations are sealed with DELTA®-FASSADE TAPE.

### Step 8

#### Windows:

- These installation details for windows are a "best practices" approach that are consistent with installation options in ASTM E 2112-07 and/or AAMA 2400-02. All installation details should be confirmed prior to beginning the project with the design authority on record. It is important to integrate all construction materials to prevent potential water intrusion.
- Always install the materials and components so that the product above overlaps the product below.
- Cut the membrane from jamb to jamb across the header of the window opening. At the centre of the window opening, cut membrane down approximately 2/3 of the way from the top. From the point where the centre cut stopped, cut on approximately 45° angle to each bottom corner of the opening. At the header of the window, starting at each corner, cut on approximately 45° angle a minimum of 8" (200 mm) to create a flap. (see Detail 3)
- Fold up the top flap and temporarily tape or tack in place. Fold bottom flap inward over sill and tack in place. Cut away excess. If a window dam is being used on the bottom sill, fasten in place. Fold side flaps inward around jambs and tack in place. Cut away excess. (see Detail 4)
- Cut a length of DELTA®-FLEXX FLASHING minimum 12" (300 mm) longer than the width of the window opening. Place DELTA®-FLEXX FLASHING on sill so that the back (interior) edge is even with the back (interior) edge of the sill and covers the window dam. Ensure the DELTA®-FLEXX FLASHING goes up each jamb a minimum of 6" (150 mm). Adhere the DELTA®-FLEXX FLASHING to the sill, jambs, and around rough opening, stretching to ensure a firm and tight fit into the corners. (see Detail 5)
- Prior to window installation, to ensure proper UV protection, cover DELTA®-FLEXX FLASHING that will be exposed to UV (sunlight) on the vertical wall with DELTA®-FASSADE FLASHING.
- Install window according to manufacturer's instructions. Follow window manufacturer's installation instruction to avoid any potential issues relating to the window warranty. Note that window manufacturers may require a bead of sealant behind the window flange. If sealant is being used at the bottom flange, the sealant must be discontinuous to allow for drainage. The final fenestration and flashing details are the sole responsibility of the design authority on record for the project.
- Flash the installed window in the following sequence:
  1. Install DELTA®-FASSADE FLASHING on the side flanges of window, sealing to DELTA®-FASSADE S. Ensure flashing extends 1" (25 mm) above window flange and below sill flashing.
  2. Install DELTA®-FASSADE FLASHING across header flange of window, sealing to DELTA®-FASSADE S. Ensure the head flashing extends beyond the outer edge of jamb flashing. (see Detail 6)
- Fold down the header flap of DELTA®-FASSADE S and apply DELTA®-FASSADE TAPE or DELTA®-FASSADE FLASHING to the 45° slits. (see Detail 7)

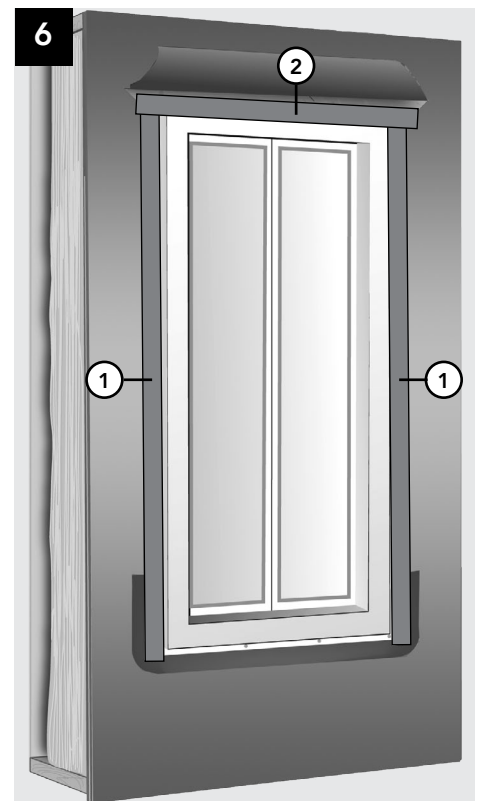

## Step 9

### Inspection:

- Inspect the DELTA®-FASSADE S for rips, tears, or other deficiencies in the continuity. Tape rips, tears or holes smaller than 2" (50 mm) with DELTA®-FASSADE TAPE. (see Detail 8)
- For holes greater than 2", a patch is required:
  - Cut a slit approximately 3" (8 cm) above the hole and approximately 3" (8 cm) wider than the hole. (see Detail 9)
  - Cut a patch minimum 6" (15 cm) larger than the hole.
  - Slide the top edge up into the cut slit so that the patch covers the hole. (see Detail 10)
  - Tape the patch in the following order: (see Detail 11)
    1. Bottom
    2. Sides
    3. Top
- To ensure continuity and air-tightness, check that all horizontal and vertical laps are sealed with DELTA®-FASSADE TAPE, DELTA®-FASSADE FLASHING or DELTA®-THAN.

For technical support, call our technical support team at 1-888-4DELTA4 (1-888-433-5824) extension 326, or visit [www.cosella-dorcken.com](http://www.cosella-dorcken.com).

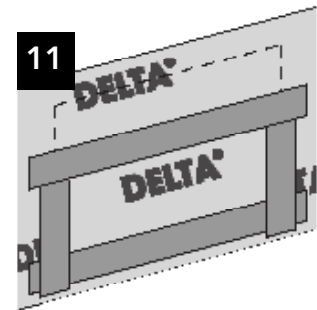
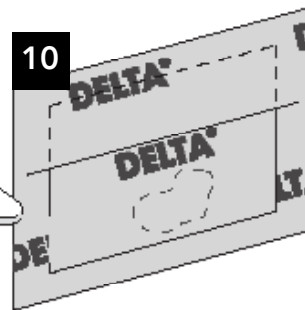
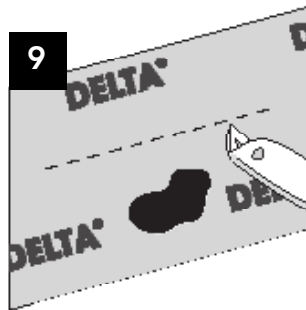
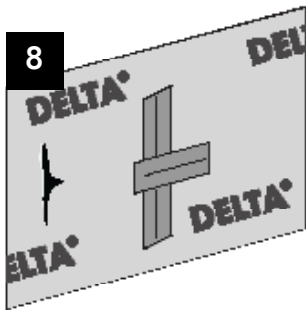

**COSELLA DÖRKEN**  
Cosella-Dörken Products Inc.  
4655 Delta Way  
Beamsville, Ontario  
L0R 1B4  
(905) 563-3255  
Fax: (905) 563-5582  
1-888-4 DELTA 4  
[info@cosella-dorcken.com](mailto:info@cosella-dorcken.com)  
[www.delta-wrb.com](http://www.delta-wrb.com)

A company of the Dörken Group

The information printed in this brochure reflects product information and specifications at the date of printing. The manufacturer reserves the right to make changes when necessary. All rights reserved.



Canadian  
Home Builders'  
Association

DELTA®-branded quality products  
manufactured by Cosella-Dörken.